



Features

Kurba Large 3D Bending is a dot free direct view, highly versatile, energy efficient and flexible LED strip suitable for outdoor wet locations capable of horizontal/side bends and vertical/top bends with a 6" bending radius. The silicone material offers excellent heat, weather, UV, and solvent resistance and has a special coating to repel dust and dirt accumulation.

Applications

Indoor/Outdoor dry & wet location

Materials

Silicone for red list approved, as well as heat, weather, UV, and solvent resistance

Dimming

Dimable down to 1%. Dot Free even illumination.

Average Life (L70)

50,000 hours

Approvals

24VDC Class 2 wet listed, IP68

Warranty

5 years

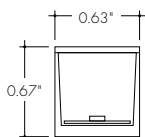

Finish Options (see page 2 for additional information)

Base ☐ White



Technical Information

Bending Direction	3D
Output	TW9450
Light Output	187 lm/ft
Average Power Consumption at 4'	3.66 W/ft
Efficacy	51 lm/W
Ordering Increment	1.79"
Maximum Run Length (In Series)	19'
Operating Temperature	-40°F to 131°F
Control/Dimming Protocol	0-10V, DMX

Constraints

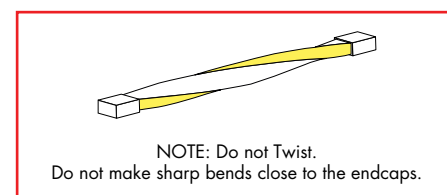
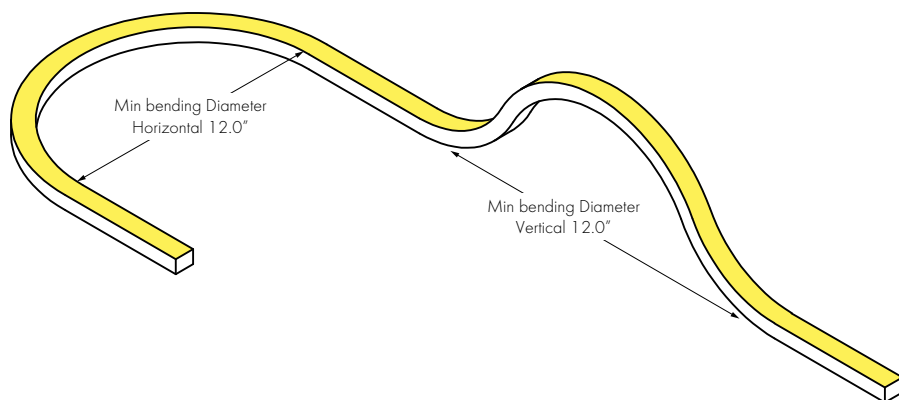

Ordering Code

MODEL	BEND DIRECTION	LENGTH	OUTPUT ¹	CCT	CRI	LENS	MOUNTING	FINISH	FEED POSITION LEFT	FEED POSITION RIGHT
KBLW-Kurba Large, Wet	3D-3D Bending	SEE PCC CHART ON PAGES 5	TW9450-Tunable White, Standard Output	27K57K-Tunable White, 2700K-5700K	R90-90 CRI	SF-Silicone Frosted	NA-See Page 4 for orderable mounting accessories	WH-White	INJECTION MOLD IME-End Feed 1 IMB-Back Feed 1 IMSA-Side 1 Feed IMSB-Side 2 Feed NPF-No Power Feed ²	INJECTION MOLD IME-End Feed 1 IMB-Back Feed 1 IMSA-Side 1 Feed IMSB-Side 2 Feed NPF-No Power Feed ²

²Feeds come with 118" wire leads

¹ - NPF-NPF for Feed Position 1&2 is not a valid configuration option

Powerfeeds and Connectors

Power Feed Position Options and Orientation

POWER FEEDS
IME - End Feed
IMB - Back Feed
IMSA - Side 1 Feed
IMSB - Side 2 Feed

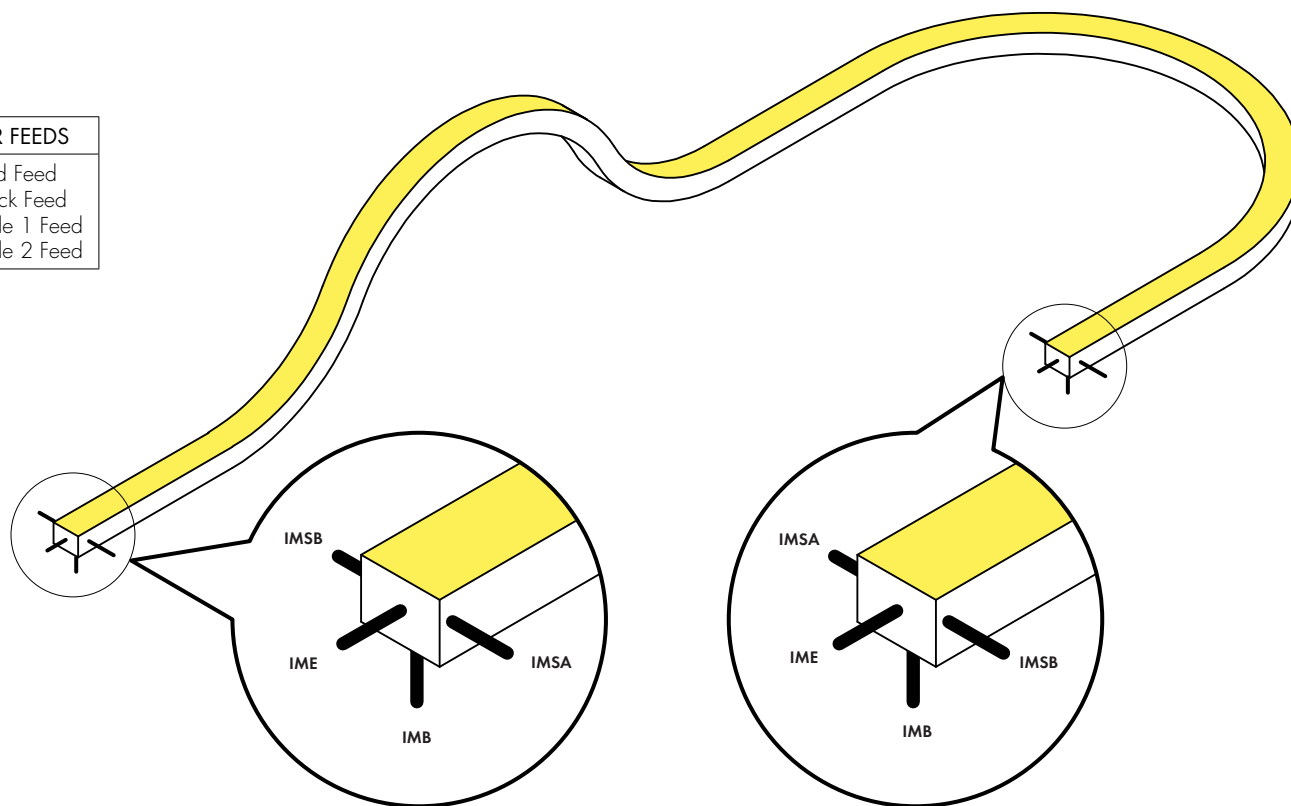

Linking and Extension Cable Options

END CONNECTOR

Injection-molded End Connector
-IME

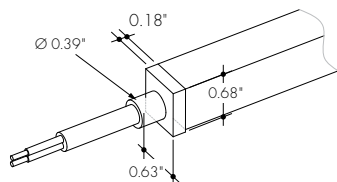

BACK CONNECTOR

Injection-molded Back Connector
-IMB

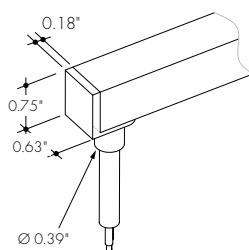

SIDE CONNECTOR

Injection-molded Side Connector
-IMSA and -IMSB

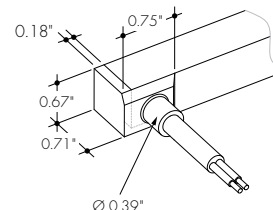

ENDCAP (NO CONNECTOR)

Injection-molded Cap (No Connector)
-NPF

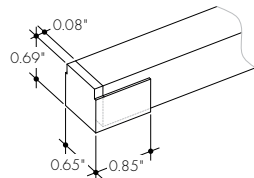

ANTI-WICKING FERRULE

Included on every power feed wire

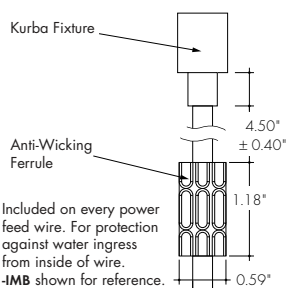

POWER FEED OPTIONS

Feeds come with 118" wire leads

WH



Tunable White
3 Conductor, 18 AWG

Product Dimensions

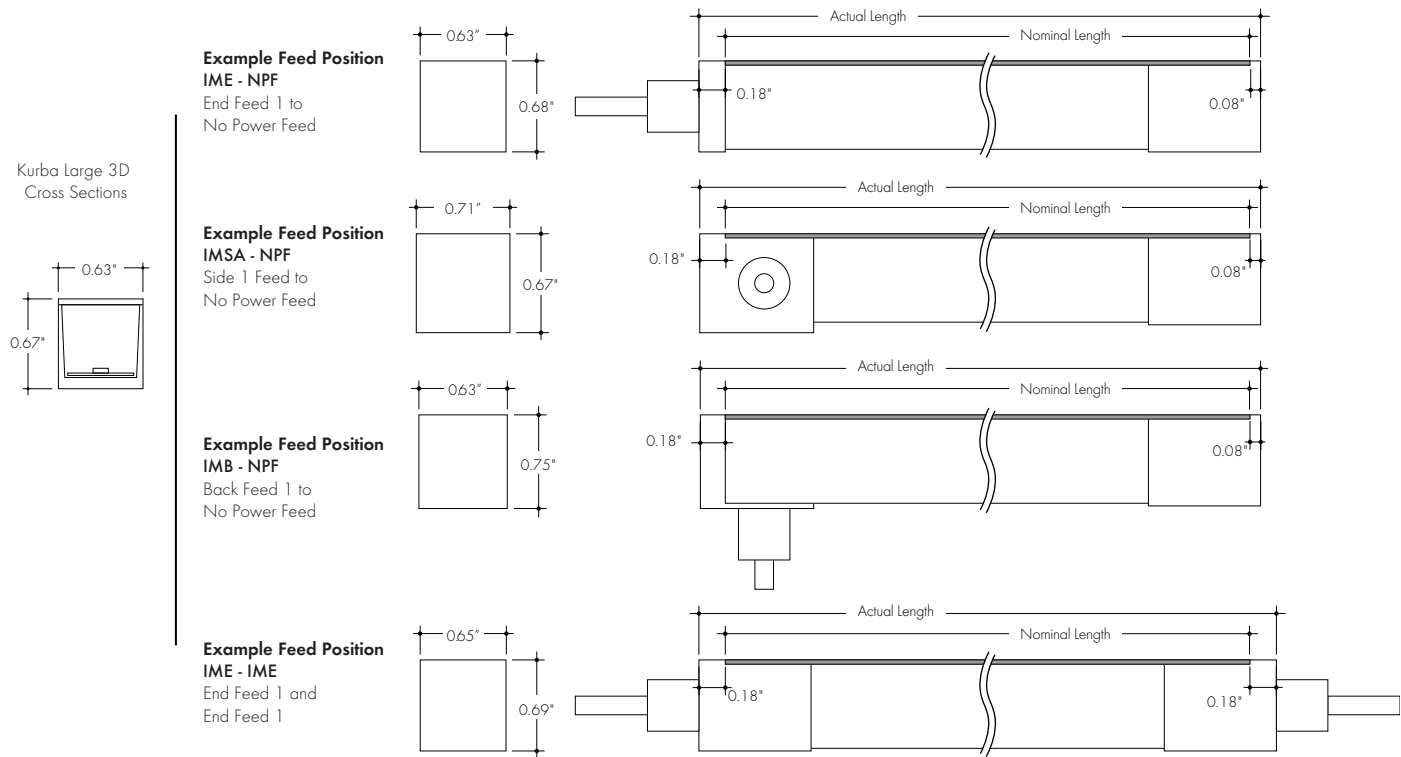

Finish Options



Light Transmission and Dotting

	Lens/Accessory
Output Options	Silicone Frosted/ White Finish
TW94SO	ND
Transmission Percentage	100%



CD SD ND
CD - Clear Dotting
SD - Slight Dotting
ND - No Dotting

Mounting Accessories

MC-KBL-BANP-3D-SM-39-XX
KBL Mounting Channel, Bendable Silicone Profile,
3D Bending, Surface Mount, 39", 6" bending radius

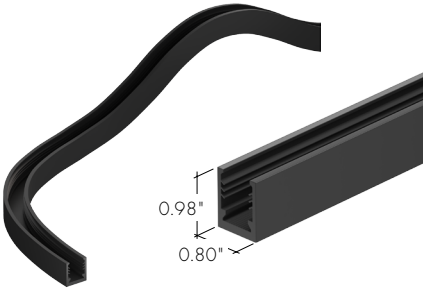

XX	Color
WH	White
BK	Black

LVSP-WET
Splice box: wet rated, low voltage, gray, IP66

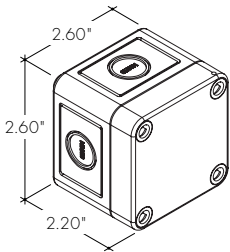

LVSP-WET-CM
Connector for splice box, low voltage for cable
management, gray

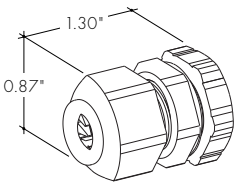

TW94SO | Power Consumption Per Fixture Length

Based on operation with PS-UNI series of power supplies. Use Actual Length for Order Code Entry.
Tolerance for Actual Lengths less than 6 ft is $\pm 0.2"$, Actual Lengths between 6 ft and 16 ft is $\pm 0.3"$, and Actual Lengths greater than 16 ft is $\pm 0.6"$
A - Power Feeds at both ends of Kurba (0.18" + 0.18" added to overall length)
B - Powerfeed at one end of Kurba and No Power Feed (NPF) at other end of Kurba (0.18" + 0.08" added to overall length)

Actual Length (in)				Actual Length (in)				Actual Length (in)				Actual Length (in)			
Nominal Length (in)	W	A	B	Nominal Length (in)	W	A	B	Nominal Length (in)	W	A	B	Nominal Length (in)	W	A	B
6	1.7	5.7	5.6	70	21.4	70.1	70	135	41	134.6	134.5	199	60.7	199	198.9
8	2.3	7.5	7.3	(6FT) 72	21.9	71.9	71.8	136	41.6	136.4	136.3	201	61.2	200.8	200.7
10	2.8	9.3	9.1	74	22.5	73.7	73.5	138	42.1	138.1	138	202	61.8	202.6	202.5
11	3.4	11.1	10.9	76	23	75.5	75.3	140	42.7	139.9	139.8	(17FT) 204	62.3	204.3	204.2
(1FT) 13	3.9	12.9	12.7	77	23.6	77.3	77.1	142	43.2	141.7	141.6	206	62.8	206.1	206
15	4.5	14.7	14.5	79	24.1	79.1	78.9	143	43.8	143.5	143.4	208	63.4	207.9	207.8
16	5	16.5	16.3	81	24.7	80.9	80.7	(12FT) 145	44.3	145.3	145.2	210	63.9	209.7	209.6
18	5.6	18.3	18.1	83	25.2	82.7	82.5	147	44.8	147.1	147	211	64.5	211.5	211.4
20	6.1	20	19.9	(7FT) 84	25.8	84.5	84.3	149	45.4	148.9	148.8	213	65	213.3	213.2
22	6.7	21.8	21.7	86	26.3	86.2	86.1	151	45.9	150.7	150.6	215	65.6	215.1	215
(2FT) 24	7.2	23.6	23.4	88	26.8	88	87.9	152	46.5	152.5	152.4	(18FT) 217	66.1	216.9	216.8
25	7.7	25.4	25.2	90	27.4	89.8	89.6	154	47	154.2	154.1	219	66.7	218.7	218.6
27	8.3	27.2	27	92	27.9	91.6	91.4	(13FT) 156	47.6	156	155.9	220	67.2	220.5	220.4
29	8.8	29	28.8	93	28.5	93.4	93.2	158	48.1	157.8	157.7	222	67.8	222.2	222.1
31	9.4	30.8	30.6	95	29	95.2	95	160	48.7	159.6	159.5	224	68.3	224	223.9
33	9.9	32.6	32.4	(8FT) 97	29.6	97	96.8	161	49.2	161.4	161.3	226	68.8	225.8	225.7
34	10.5	34.4	34.2	99	30.1	98.8	98.6	163	49.8	163.2	163.1	227	69.4	227.6	227.5
(3FT) 36	11	36.1	36	101	30.7	100.6	100.4	165	50.3	165	164.9	(19FT) 229	69.9	229.4	229.3
38	11.6	37.9	37.8	102	31.2	102.4	102.2	167	50.8	166.8	166.7	231	70.5	231.2	231.1
40	12.1	39.7	39.5	104	31.8	104.1	104	(14FT) 168	51.4	168.6	168.5	233	71	233	232.9
42	12.7	41.5	41.3	106	32.3	105.9	105.8	170	51.9	170.4	170.3	235	71.6	234.8	234.7
43	13.2	43.3	43.1	(9FT) 108	32.8	107.7	107.5	172	52.5	172.1	172	236	72.1	236.6	236.5
45	13.7	45.1	44.9	109	33.4	109.5	109.3	174	53	173.9	173.8				
47	14.3	46.9	46.7	111	33.9	111.3	111.1	176	53.6	175.7	175.6				
(4FT) 49	14.8	48.7	48.5	113	34.5	113.1	112.9	177	54.1	177.5	177.4				
50	15.4	50.5	50.3	115	35	114.9	114.7	179	54.7	179.3	179.2				
52	15.9	52.3	52.1	117	35.6	116.7	116.5	(15FT) 181	55.2	181.1	181				
54	16.5	54	53.9	118	36.1	118.5	118.3	183	55.8	182.9	182.8				
56	17	55.8	55.7	(10FT) 120	36.7	120.2	120.1	185	56.3	184.7	184.6				
58	17.6	57.6	57.4	122	37.2	122	121.9	186	56.8	186.5	186.4				
59	18.1	59.4	59.2	124	37.8	123.8	123.6	188	57.4	188.2	188.1				
(5FT) 61	18.7	61.2	61	126	38.3	125.6	125.4	190	57.9	190	189.9				
63	19.2	63	62.8	127	38.8	127.4	127.3	(16FT) 192	58.5	191.8	191.7				
65	19.7	64.8	64.7	129	39.4	129.2	129.1	193	59	193.6	193.5				
67	20.3	66.6	66.4	131	39.9	131	130.9	195	59.6	195.4	195.3				
68	20.8	68.4	68.2	(11FT) 133	40.5	132.8	132.7	97	60.1	197.2	197.1				

Note: all values are rounded to the nearest 0.1 inch

Endcap (No Connector) -NPF

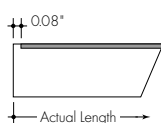

End Connector -IME

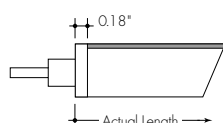

Back Connector -IMB

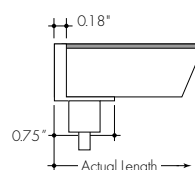

Side Connector -IMSA -IMSB

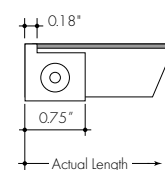

Power Supplies

See fixture and power supply instructions & spec sheet for wiring information. Dimming possible in select models - view Luminii website for list of compatible dimmers.

For use with Tunable White

Ordering Code - DALI2 Dimming Power Supplies 0.1% 120VAC - 277VAC

MODEL	INPUT CONTROL	ENVIRONMENT	WATTAGE	OUTPUT
PS - Power Supply, 120-277VAC	DALI2-DT8 - DALI DT8 Tunable White (0.1%)	D - Dry	96 - 96 Watts	24 - 24 VDC

MODELS	96W
Length	14.40"
Width	5.20"
Depth	2.60"

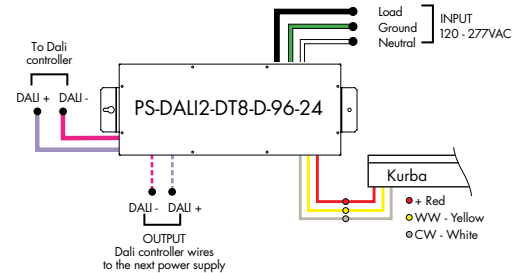

Ordering Code - Athena DALI2 Dimming Power Supplies 0.1% 120VAC - 277VAC

MODEL	INPUT CONTROL	ENVIRONMENT	WATTAGE	OUTPUT	FEATURE
PS - Power Supply, 120-277VAC	DALI2-DT8 - DALI DT8 Tunable White (0.1%)	D - Dry	96 - 96 Watts	24 - 24 VDC	AWN - Athena

MODELS	96W
Length	14.40"
Width	5.20"
Depth	2.60"

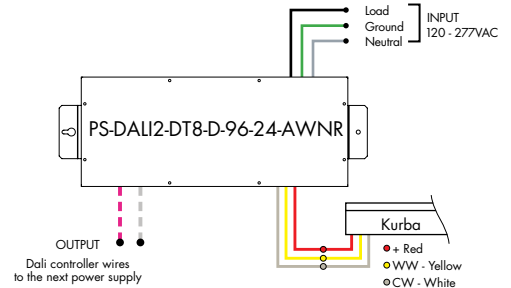

Ordering Code - DALI2 Dimming Power Supplies 0.1% 120VAC - 277VAC - for Dim-to-Warm functionality with Tunable White Output

MODEL	INPUT CONTROL	ENVIRONMENT	WATTAGE	OUTPUT
PS - Power Supply, 120-277VAC	DALI2-WD - DALI2 DT6 Warm Dim (0.1%)	D - Dry	96 - 96 Watts	24 - 24 VDC

MODELS	96W
Length	14.40"
Width	5.20"
Depth	2.60"

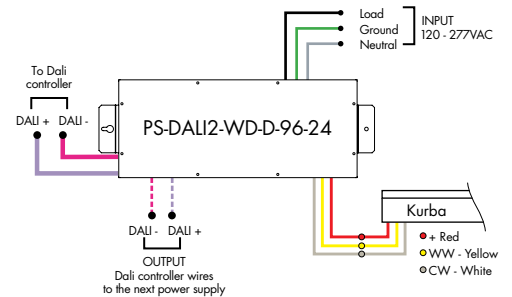

Ordering Code - DMX Dimming Power Supplies 0.1% 120VAC - 277VAC

MODEL	INPUT CONTROL	ENVIRONMENT	WATTAGE	OUTPUT
PS - Power Supply, 120-277VAC	DMX - DMX (0.1%)	D - Dry	96 - 96 Watts 3X96 - 3X96 Watts	24 - 24 VDC

MODELS	96W	3X96
Length	14.40"	15.00"
Width	5.20"	6.62"
Depth	2.60"	4.56"

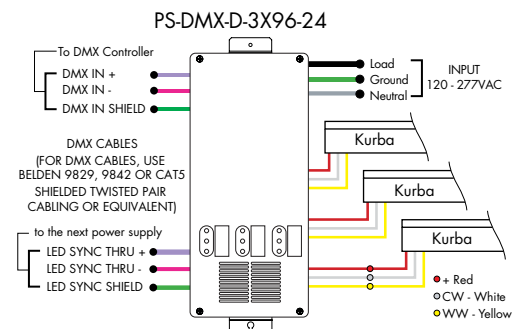
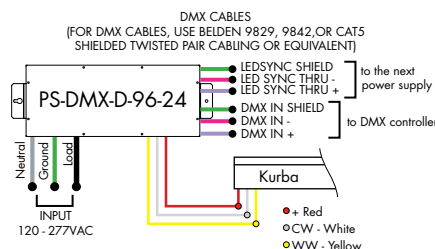

Power Supplies

See fixture and power supply instructions & spec sheet for wiring information. Dimming possible in select models - view Luminii website for list of compatible dimmers.

For use with Tunable White

Ordering Code - VintageDim® 0-10V Dimming Power Supplies 0.1% 120VAC - 277VAC

MODEL	INPUT CONTROL	ENVIRONMENT	WATTAGE	OUTPUT
PS - Power Supply, 120-277VAC	010V-WD - 0-10V Dimming (0.1%), Standard Warm Dim Curve (with Tunable White LED) 010V-TW - 0-10V Dimming (0.1%), Two Channel Control, Brightness and CCT1-CCT2 Ratio 010V-2CH - 0-10V Dimming (0.1%), Two Channel Control, LED1 Brightness and LED2 Brightness 010V-WDX - 0-10V Dimming (0.1%), Customizable Warm Dim Curve (with Tunable White LED) 010V-2CHX - 0-10V Dimming (0.1%), Two Channel Control, Customizable Brightness and CCT1-CCT2 Ratio	D - Dry	96 - 96 Watts 3X96 - 3x96 Watts ¹	24 - 24 VDC

1 - 3x96 is only available with input control options 010V-WD and 010V-TW

MODELS	96W	3X96
Length	14.40"	15.00"
Width	5.20"	6.62"
Depth	2.60"	4.56"

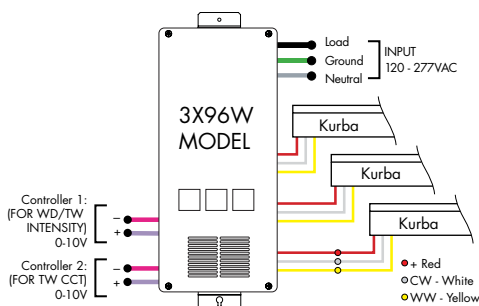
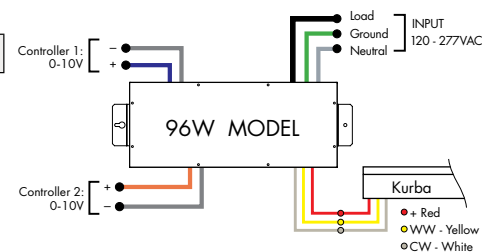

Ordering Code - Athena VintageDim® 0-10V Power Supply 0.1% 120VAC - 277VAC - for Dim-to-Warm functionality with Tunable White Output

MODEL	INPUT CONTROL	ENVIRONMENT	WATTAGE	OUTPUT	FEATURE
PS - Power Supply, 120-277VAC	010V-WD - 0-10V Dimming, Standard Warm Dim Curve (with Tunable White LED)	D - Dry	96 - 96 W	24 - 24 VDC	AWN - Athena

MODELS	96W
Length	14.40"
Width	5.20"
Depth	2.60"

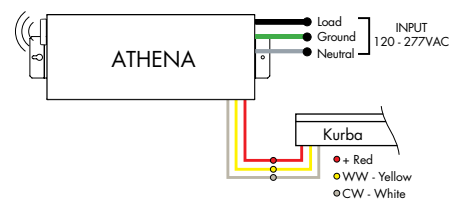

Ordering Code - Athena VintageDim® 0-10V Two Channel LED Driver, 0.1% 120VAC - 277VAC

MODEL	INPUT CONTROL	ENVIRONMENT	WATTAGE	OUTPUT	FEATURE
PS - Power Supply, 120-277VAC	010V-2CH - 0-10V Dimming Two Channel Control, LED1 Brightness and LED2 Brightness	D - Dry	96 - 96 W	24 - 24 VDC	AWN - Athena

MODELS	96W
Length	14.40"
Width	5.20"
Depth	2.60"

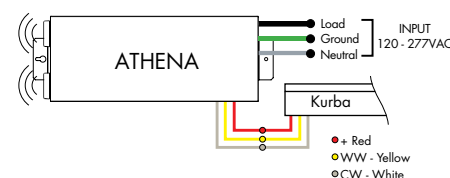

Controllers and Decoders

For use with Tunable White Power Supplies



ORDERING CODE

MODEL

DTW-MC

DTW-MC - Tunable White controller

Tunable White wall-mount controller controls lighting fixtures, wireless control of TW lighting fixture. Fits in any standard US switch box. Includes all the outputs in the back of the controller.

Features

- Switch & dimming control function, control range > 20M.
- Smooth transition between light levels.
- Separately operate dimming and color temperature functions.
- Able to control 1 zone with endless receivers. Each receiver can maximally be controlled by 8 remotes.
- Power, temperature color and dimming functions operated by push button after receivers are connected.

Operating Voltage

3V DC battery

Color Parameters

- Brightness
- Saturation
- Fading



ORDERING CODE

MODEL

TW-DMX

TW-DMX - DMX controller

Tunable White DMX wall-mount controller is a fully touch sensitive controller designed in accordance with standard protocol DMX512. Offers fast and accurate color temperature adjustment and brightness dimming of natural white, warm white and cold white. Designed with a touch color wheel, the DMX512 controller can adjust color temperature and brightness for all white LEDs smoothly and accurately. The DMX controller can control 1 zone with endless decoders.

Features

- 1 zone
- 6 color scenes
- DMX Control
- Touch Sensitive Glass Surface
- Dimming and Speed Control
- Memory Function
- Easily Fits Standard US Switch Boxes

Operating Voltage

12 - 24V DC

Color Parameters

- Brightness
- Saturation
- Primary colors
- Fading
- Color changing speed



ORDERING CODE

MODEL

SLD-DIMTW

SLD-DIMTW - Tunable white LED dimming module

The SLD DimTW is a constant voltage warm dimming LED dimming module. The unique dimming module accepts 0-10V control and mimics a smooth, incandescent dimming curve.

Features

- Flicker free 0-100% dimming
- High efficiency up to 97%
- High precision dimming ratio:>1:1000
- Fully isolated plastic housing
- Comply with EN55015 and FCC part 15 without additional input filter and capacitors
- compact size, high reliability
- 3 years warranty

Operating Voltage

8-48 VDC

Controllers and Decoders

For use with Tunable White, RGB/RGBW Power Supplies



ORDERING CODE

MODEL

DDMX-RGBW

DDMX-RGBW - DMX decoder

Translates controller DMX512 programs for RGB and white LED strips.

Unique DMX address for the decoder can be set easily and displayed by the numeric display on the case. Changing and resetting the DMX address requires manual input.

Use power repeater to expand output.

Operating Voltage

12-36 VDC

Power Capacity

up to 96W at 24V

Operating Temperature Range

from -4°F to +122°F in case



ORDERING CODE

MODEL

RGBW-RC-R

RGBW-RC-R - RGBW receiver

The RGBW receiver is easily paired with controller by the click of a button. Receiver can be reset to factory settings at any time.

Each receiver can store one static RGB color, one color sequence, and one brightness setting for the white LED strip. Receivers assigned to the same scene within the same zone will have the same LED static color and color sequence.

Operating Voltage

12-36 VDC

Power Capacity

up to 96W at 24V

Operating Temperature Range

from -4°F to +122°F in case



ORDERING CODE

MODEL

RGBW-SR

RGBW-SR - RGBW signal repeater

Extends identical signal when connected in series to an RGBW LED control system. The RGBW signal repeater works with Luminii RGB and RGBW controllers, receivers, and decoders.

RGBW signal can be extended indefinitely when adequate power supply (not included) is connected to the system.

Operating Voltage

12-36 VDC

Power Capacity

up to 96W at 24V

Operating Temperature Range

from -4°F to +122°F in case

Controllers and Decoders

For use with Tunable White, RGB/RGBW Power Supplies

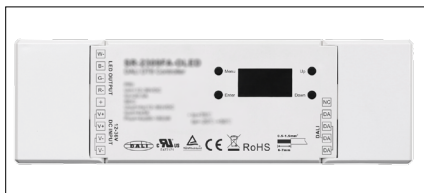

ORDERING CODE

MODEL

DALI2-DT8-RGBW

DALI2-DT8-RGBW - DALI-2 RGBW Decoder

A 4-channel DALI2 DT8 decoder designed to control RGB, RGBW, and TW LED fixtures, featuring adjustable color temperature and customizable lumen output.

Voltage/Frequency
12-36VDC

Max Output Power
4 output channels, 60-180W each

Max Output Current
4 output channels, max of 5A each

Ambient Operating Temperature Range
-20 to 50°C

Environment
Dry (IP20)



ORDERING CODE

MODEL

DDMX-5CH-RDM-PRO

DDMX-5CH-RDM-PRO - DMX512 Decoder

DMX512 decoder with RDM functionality features 5 PWM output channels with common anode. High PWM output frequency range allows the product to be used in HD video conferencing spaces. All DMX products to be installed per DMX512 Standard.

Power

96 Watt

Inputs

RJ45, XLR-5Pin, Terminal Block

DMX Channels

1 to 5 settable

PWM Output Resolution Ratio

8 or 16 bit

PWM Output Frequency

500Hz - 30KHz

Output Dimming Curve Gamma Value

0.1 ~ 9.9



ORDERING CODE

MODEL

RGBW-WI-R

RGBW-WI-R - WIFI generator

RGBW-WI-R creates a local network that enables any electronic device (phone, tablet, etc.) to control the RGB/WV strip connected to a RGBW-RC-R receiver.

The control functions are achieved through a free application download for Android and iOS devices called REALCOLOR.

Operating Voltage

12-36 VDC

Power Supply

PI-130-24 (included)

Operating Temperature Range

from -4°F to +122°F in case

For use with Tunable White, RGB/RGBW, Pixel Power Supplies

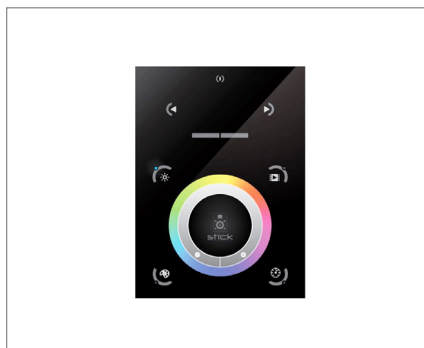

ORDERING CODE

MODEL

TSDMX-E

TSDMX-E - Touchscreen DMX controller

Programmable advanced DMX512 lighting controller featuring a touch-screen interface. Operates as stand alone controller or integrated with most architectural lighting control systems. Can controller endless DMX512 enabled devices.

Mounts to standard single or dual gang wall box with the included power supply inside the junction box. Terminal block design for power and data connections.

Features

- Sleek glass design which sits 0.43" from the wall
- Graphical color display to show selected environment
- Color/dimmer/speed palette
- Color temperature mixing
- Touch sensitive buttons. No mechanical parts
- Touch sensitive wheel allows for accurate color selection
- Multi-zone microSD memory
- Multi-room control with 500 scenes, 10 zones
- 1024 DMX channels. Control 340 RGB fixtures
- USB & Ethernet connectivity for programming and control

Power Supply

7 VDC (included)

Programmability

PC, Mac, Tablet, Smartphone

Output Signal

DMX512 (1024 channels)

Color Parameters

- Brightness
- Saturation
- Speed of color changing sequence
- Fading / dimming / brightness