

# LETO 5

TRACK LED SPOTLIGHT

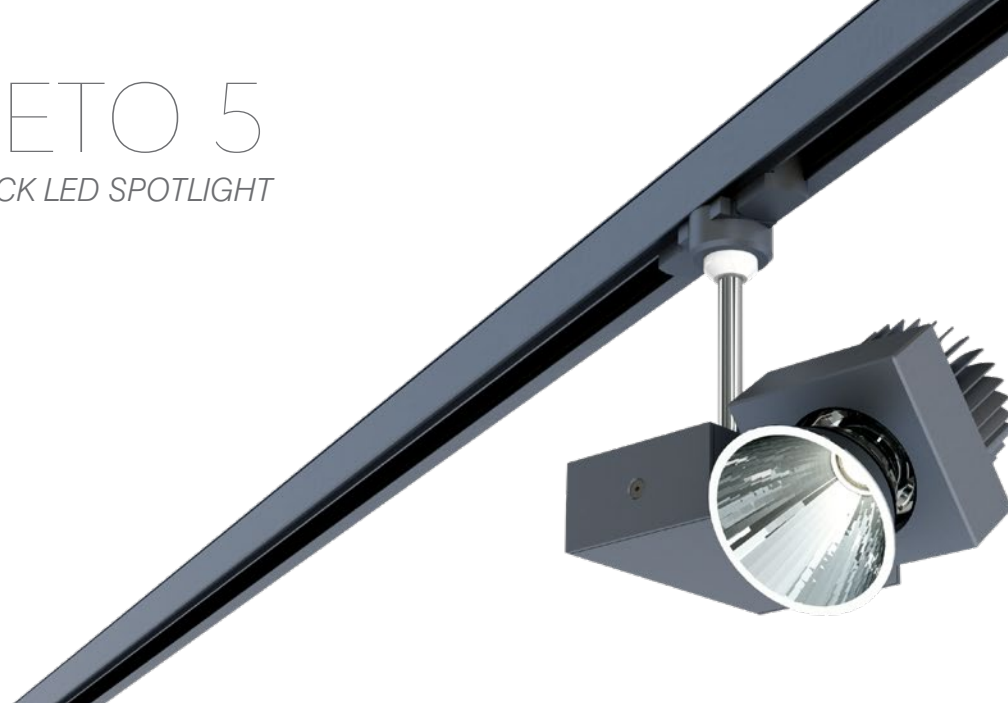

**Leto 5 - Track Mount Spotlight.** The Leto 5 spotlight track system blends style together with multiple levels of application and uses; a favorite with museums and art enthusiasts alike. It comes with fully controllable directional adjustments.

## Ordering Code

Fixture	<b>650</b>					
	1	2	3	4	5	6
Driver			--	--		
	1	2	3	4		

## Product Specifications

**SAMPLE:** Fixture **650 - A90 - 618 - 27 - 07 - 02** | Driver **STD - 120 - A90 - 07**

1 - Model	2 - LED	3 - Optic	4 - CCT	5 - Lumen	6 - Finish
<b>650</b> · Leto 5 One Circuit <b>651</b> · Leto 5 Two Circuit <b>649</b> · Leto 5 Three Circuit <sup>*1</sup>	<b>A90</b> · 93+ CRI Accuracy	<b>618</b> · 18° <b>630</b> · 30° <b>645</b> · 45° <b>660</b> · 60°	<b>25</b> · 2500K <b>27</b> · 2700K <b>30</b> · 3000K <b>35</b> · 3500K <b>40</b> · 4000K <b>65</b> · 6500K	<b>07</b> · 700 (8.2W) <b>10</b> · 1000 (11.2W) <b>15</b> · 1500 (18.2W)	<b>01</b> · White <b>02</b> · Black <b>08</b> · Silver <b>XX</b> · Custom

1 - Driver	Dim Level	2 - Voltage	3 - LED	4 - Lumen	
<b>STD</b> · Non Dimming <b>LCS</b> · 0 - 10 Volt Protocol <b>DIM</b> · Phase <sup>*2</sup>	N/A 10% 10%	<b>120</b> · 120V <b>277</b> · 277V	Same as Fixture	Same as Fixture	Project : _____ Quantity : _____ Type : _____ Notes : _____

<sup>\*1</sup> 120V only

## Accessories

### Barn-Door

- Limits the glare and allows you to control the direction of a light beam
- Flaps can be adjusted and lock in place
- Steel construction
- Satin powder coat finish



### Louver

- 95% open area with 45° cut-off
- Made from cold-rolled steel
- Black polymer coating with eggshell finish



### Acrylic ring

- Rigid frosted acrylic
- Creates an accent detail for subtle diffused light



## General

- 350° rotation
- 0° to 130° tilt and lock
- Includes track adapter (single or dual phase)

## Construction / Finish

- Cast Aluminum Trim and Steel Casing
- Satin powder coat finish
- Made in Canada

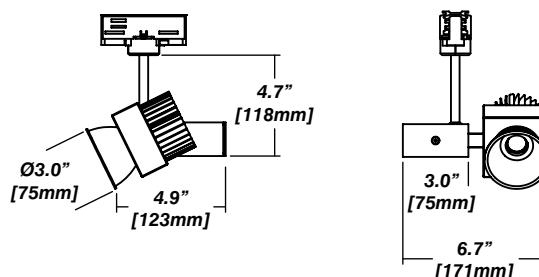

## Reflector

### Faceted Reflector

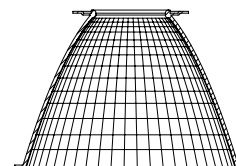

## 1 / 2 / 3 Circuit Switch

When the track is connected to a two or three-circuit system, it is possible to select the phase (L1, L2 or L3) of each luminaire in your system using the selector under the adapter.

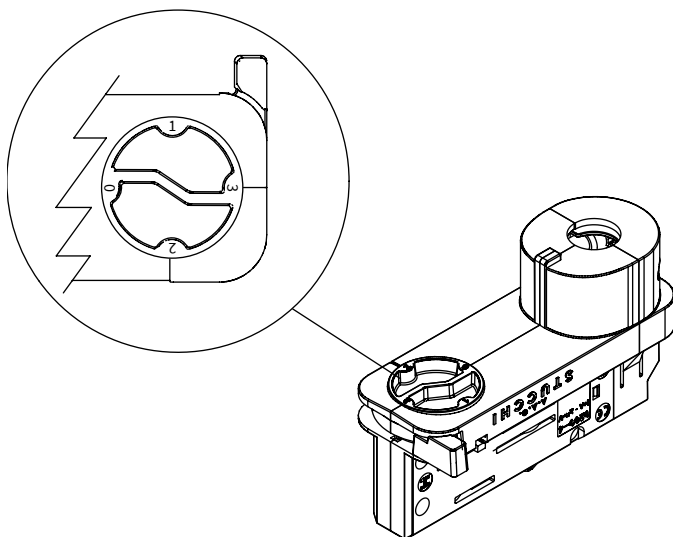

# LETO 5

## TRACK LED SPOTLIGHT



### Photometrics

Senso's in-house photometric testing ensures that our lighting design can match your needs precisely. Our Goniophotometer and testing lab produces on-demand photometry files based on any specified fixture, including LM-79 Test reports, IES Files, and CRI/CCT measurements. See [Sensolighting.com](http://Sensolighting.com) for more information.

*\*Full photometric Reports and IES files available for every configuration*

### Color Metrics

#### TM 30-15

Our clients deserve the best information possible about their lighting choices. That's why Senso has invested in the Illuminating Engineering Society (IES) TM 30-15, a new system that measures an LED light source's color rendering properties. Using Senso's state-of-the-art goniophotometer, this method identifies the optimal light source for your project and helps evaluate the trade-offs between efficacy and color rendering. Senso can provide TM 30-15 data for all of our products.

*\*Full Color Metric Info Available at [Sensolighting.com](http://Sensolighting.com)*

### LED Module Performance

**Output:** Up to 89 lumen/Watt

**Efficacy:** Color consistency within a 3-MacAdam Ellipse

**CCT:** 2500K - 6500K

**Color Rendering:** 93+ CRI

**Min. R Values:** R<sup>9</sup> - 60 R<sup>1</sup> - 90 R<sup>a</sup> - 100

### Driver and Power Consumption

**Dimming:** 1% dimming standard with 0.1% option  
Casambi wireless control available

**Ripple:** Industry leading Low ripple

**Efficiency:** Power Factor >0.9

Efficiency over 85%

Class 2 output for safety

**Installation:** Remote mounted

Lumen Option	700lm	1000lm	1500lm
Fixture Wattage	8.2W	11.2W	18.2W
Delivered Lumen	723lm	1015lm	1537lm