

LETO 44 PLUS

SUSPENDED ASYMMETRIC CYLINDER



Features

- Four output options available up to 2000 lumens.
- Nine drivers selections available to cover wide range of applications.
- Five year warranty.

Finish Options

- White
- Black
- Silver
- Mocha
- Charcoal
- Cerulean
- Firebrick



Declare.



Made in Canada with Imported Parts

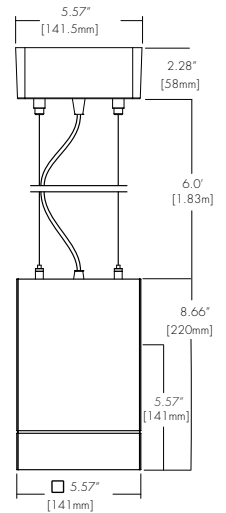
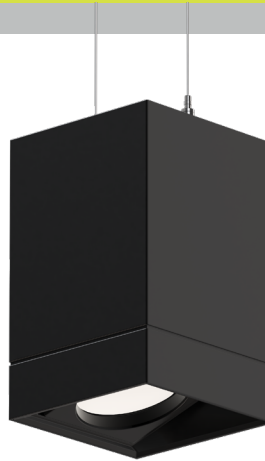

Technical Information

OUTPUT OPTIONS	700 lm	1000lm	1500lm	2000lm
Fixture wattage	6.2 W	9.6 W	14.6 W	20.5 W
Delivered Lumen at 3500K	486 lm	730 lm	1134 lm	1620 lm
Efficacy	78 lm/W	76 lm/W	78 lm/W	79 lm/W
Center Beam Candlepower	757 cd	1137 cd	1767 cd	2524 cd

CCT	Multiplier	CRI	TM-30		
			R _f	R _g	R ₉
2500K	0.80	93+	93	102	50+
2700K	0.92	93+	92	100	50+
3000K	0.97	93+	92	103	50+
3500K	1.00	93+	93	102	50+
4000K	1.07	93+	92	101	50+
6500K	1.05	93+	92	101	50+

Ordering Code

Integral Driver Example: Fixture LET44P-S-S-07-25K-ASM-DL-WH-WH-SQ-WH-SS2-WH-PHSD-NA

Remote Driver Example: Fixture LET44P-S-S-07-25K-ASM-DL-WH-WH-SQ-WH-SS2-WH-PHSD-NA-HRM-LET44P-S-S-07-25K-PHSD-NA

Fixture

MODEL	TYPE	SIZE	OUTPUT	CCT	OPTIC	ACCESSORY	BODY FINISH	BAFFLE FINISH
LET44P - Leto 44 Plus	S - Suspended	S - Small ¹ M - Medium	07 - 700 (6.2W) 10 - 1000 (9.6W) 15 - 1500 (14.6W) 20 - 2000 (20.5W)	25K - 2500K 27K - 2700K 30K - 3000K 35K - 3500K 40K - 4000K 65K - 6500K	ASM - Asymmetric	DL - Diffusing Lens	Standard WH - White BK - Black SL - Silver Premium ² MA - Mocha CC - Charcoal CR - Cerulean FB - Firebrick	Standard WH - White BK - Black SL - Silver Premium ² MA - Mocha CC - Charcoal CR - Cerulean FB - Firebrick

CANOPY/ HOUSING	CANOPY FINISH	SUSPENSION TYPE	SUSPENSION FINISH	DRIVER	DRIVER OPTIONS
RD - Round SQ - Square RTL - Round Flangeless	Standard WH - White BK - Black SL - Silver Premium ² MA - Mocha CC - Charcoal CR - Cerulean FB - Firebrick	2AF - 2AC + Feed Cable SS2 - Solid Stem, 2ft SS3 - Solid Stem, 3ft SS6 - Solid Stem, 6ft HS2 - Hang Straight, 2ft HS3 - Hang Straight, 3ft HS6 - Hang Straight, 6ft POA - 2 Powered Aircraft, 6ft	Standard NA - None ³ CL - Clear WH - White BK - Black SL - Silver ⁴ Premium ² MA - Mocha ⁴ CC - Charcoal ⁴ CR - Cerulean ⁴ FB - Firebrick ⁴	PHSD - Forward/Reverse Phase, 1% Dimming, 120V Only 010S - 0-10V, 1% Dimming, 120V/277V 0103 - 0-10V, 1% Dimming, 347V Only 010L - EldoLED, 0-10V, Linear, 0.1% Dimming, 120/277V ⁵ 010G - EldoLED, 0-10V, Log, 0.1% Dimming, 120/277V ⁵ DALI - EldoLED, DALI Protocol 2, DT-6, 0.1% Dimming, 120/277V (Standard as LOG) ^{5,10} DALI8 - EldoLED, DALI Protocol 2, DT-8, 0.1% Dimming, 120/277V (Standard as LOG) ^{7,10} LUTE - Lutron Hilume Ecodigital, 1% Dimming, 120V/277V ^{5,6} DMX - EldoLED, DMX, 0.1% Dimming, 120V/277V ⁷	NA - None EMG - Emergency Driver ^{7,8} CSMB - Casambi ⁹ AWN - Athena ⁹

1 - Size Small max output is 1500 lumens.

2 - Premium finishes may have extended lead times. Custom RALs are available, please consult Inside Sales with specific request.

3 - Must select NA None when POA 2 Powered Aircraft Suspension is selected.

4 - These finishes are only available with SSX Solid Stem or HSX Hang Straight Suspension.

5 - Requires SQ square canopy for integral driver, otherwise remote mounted.

6 - LUTE driver is not available at 700 lumens.

7 - All drivers remote mounted when using DALI8 driver, DMX driver, or EMG driver options.

8 - Emergency option comes prewired from factory with driver in remote housing. 8W of continuous power provided for a minimum of 90 minutes. Must be installed within 30 feet of luminaire using 18 AWG wire. Not available with 0103, DMX, DALI8 or LUTE Driver.

9 - AWNR/CSMB only available with 010S driver

10 - DALI and DALI8 driver options use logarithmic dimming curve as standard. For LINEAR dimming curve, add "LIN" after the dimming code, i.e. DALI LIN

CONTACT FACTORY FOR MORE OPTIONS.

LETO 44 PLUS

SUSPENDED ASYMMETRIC CYLINDER



Canopy

RD Round Canopy

	Integral Drivers	Remote Drivers
	010S 0103 PHSD	010L 010G DALI DALI8 LUTE DMX

Please see next page for Remote Driver Housing details.

RTL Round Trimless Canopy

	Integral Drivers	Remote Drivers
	N/A	010S 0103 PHSD 010L 010G DALI DALI8 LUTE DMX

SQ Square Canopy

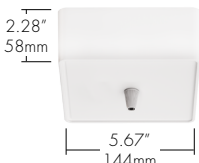
	Integral Drivers	Remote Drivers
	010S 0103 PHSD 010L 010G DALI LUTE	DALI8 DMX

Suspension

2AF 2 Aircraft + Feed Cable



SSX (2', 3', 6' max) Solid Stem



HSX (2', 3', 6' max) Hang Straight Solid Stem



Maximum Slope: 15°

POA 2 Powered Aircraft



Lens

DL Diffusing Lens



Remote Driver Housing

Depending on the options selected in the order code on page 1, a Remote Driver Housing may be required. This will automatically be generated and put on your order as necessary.

REMOTE DRIVER	MODEL	OUTPUT	CCT	DRIVER	DRIVER OPTIONS
HRM-Housing, Remote	LET44P-S-Leto 44 Plus Suspended	Same as Fixture	Same as Fixture	Same as Fixture	Same as Fixture

Maximum mounting distance to luminaire using 18 AWG wire								
PHSD	010S	0103	010L	010G	DALI	DALI8	LUTE	DMX
16'	16'	16'	72'	72'	72'	72'	15'	149'

HRM Single with Externally Mounted Driver

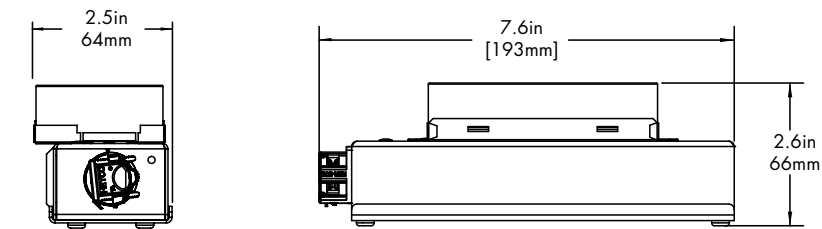

Canopy	+	Driver
RTL	+	0103
RD or RTL	+	010L
RD or RTL	+	010G
RD or RTL	+	DALI
RD or RTL	+	LUTE

HRM Single

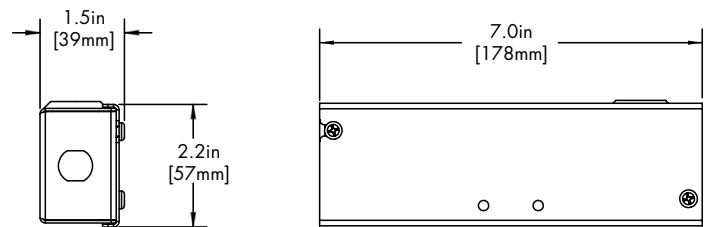

Canopy	+	Driver
RTL	+	PHSD
RTL	+	010S

HRM Double

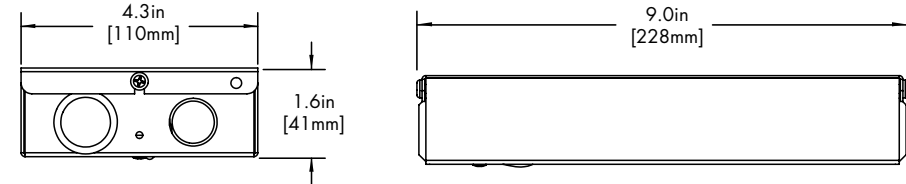

Driver
DALI8
DMX

EMG Emergency Driver

120 minute EMG operation time.

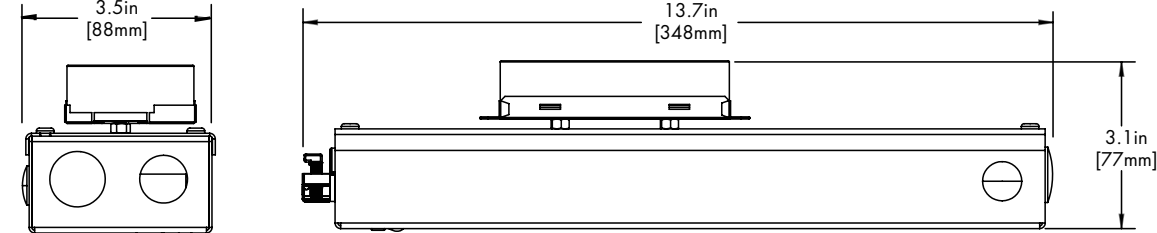

Driver
EMG

LETO 44 PLUS

SUSPENDED ASYMMETRIC CYLINDER



Standard Finish

BK
Black



WH
White



SL
Silver



Premium Finish

Two tone with Black Baffle Finish. Any combination may be used for baffle and body finishes.

MA
Mocha



CC
Charcoal



CR
Cerulean

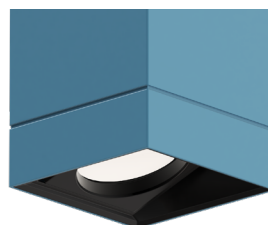

FB
Firebrick

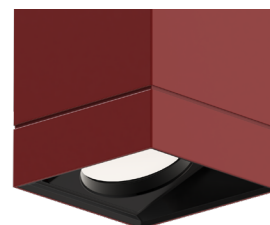

TM-30

2500K

COLOR VECTOR GRAPHIC

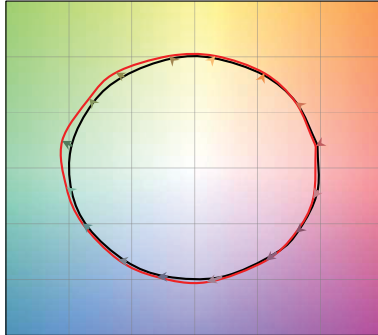

— Reference Source — Test Source

2700K

COLOR VECTOR GRAPHIC

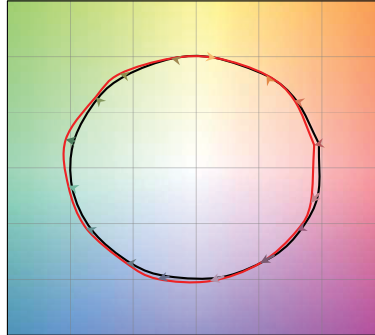

— Reference Source — Test Source

3000K

COLOR VECTOR GRAPHIC

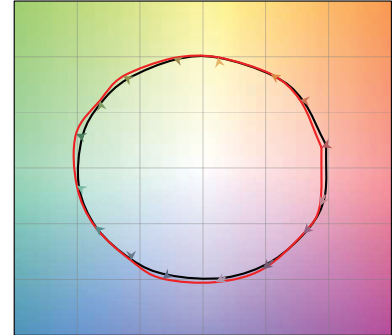

— Reference Source — Test Source

3500K

COLOR VECTOR GRAPHIC

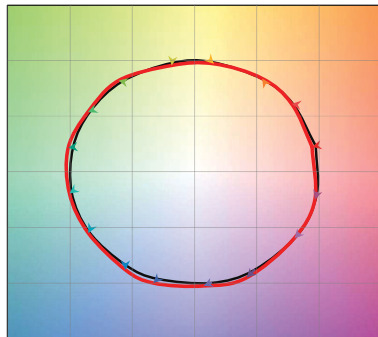

— Reference Source — Test Source

4000K

COLOR VECTOR GRAPHIC

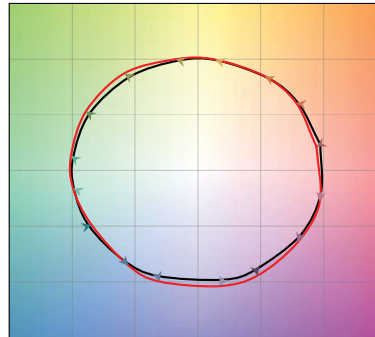

— Reference Source — Test Source

6500K

COLOR VECTOR GRAPHIC

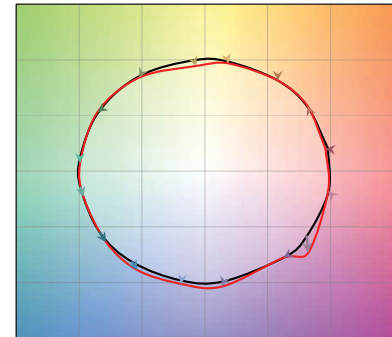

— Reference Source — Test Source

Photometry

ASM - Asymmetric

