

mCove - Installation Instructions

Models M-

Please read all instructions prior to installation and keep for future reference!

1. PRODUCT TO BE INSTALLED BY A QUALIFIED ELECTRICIAN.
2. USE ONLY WITH CLASS 2 POWER UNIT.
3. 24 VOLTS DC.
4. SUITABLE FOR DAMP LOCATIONS.
5. SURFACE MOUNT ONLY.
6. SUITABLE FOR INSTALLATION WITHIN THE CLOSET STORAGE SPACE.
7. INHERENTLY PROTECTED.
8. FIXTURE SHOULD BE INSTALLED BY TWO PEOPLE.



REV.0.2
01272026

1 / 4



7777 Merrimac Ave
Niles, IL 60714
T 224.333.6033
F 224.757.7557
info@luminii.com
www.luminii.com

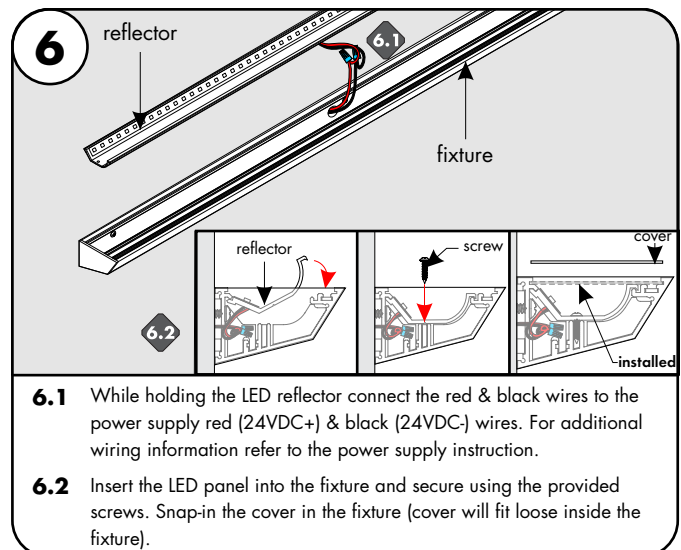
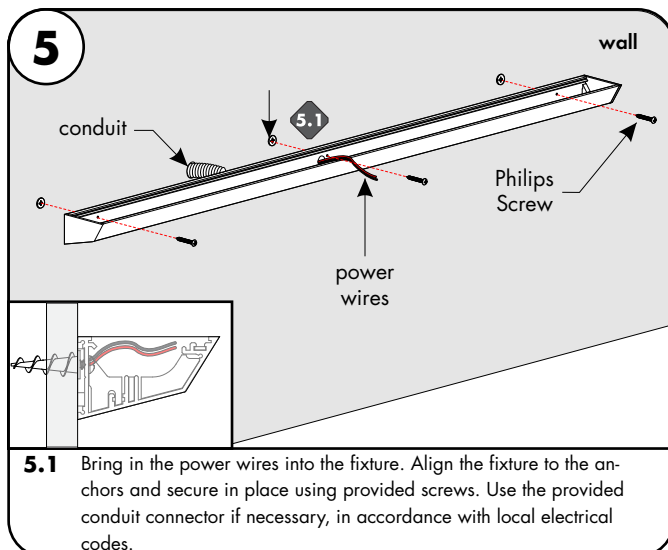
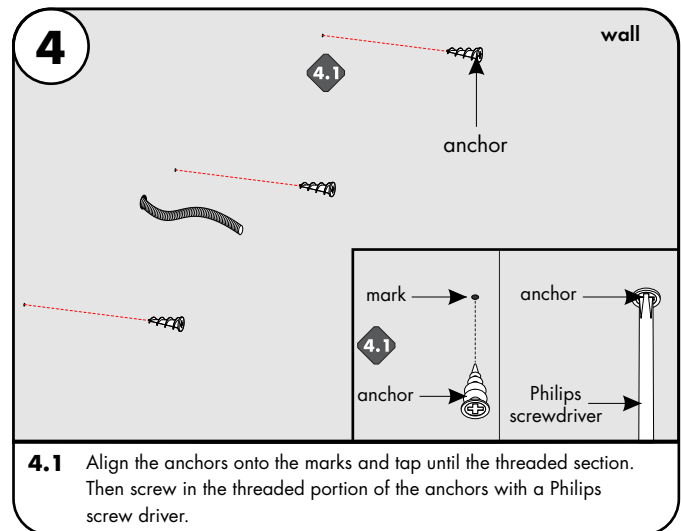
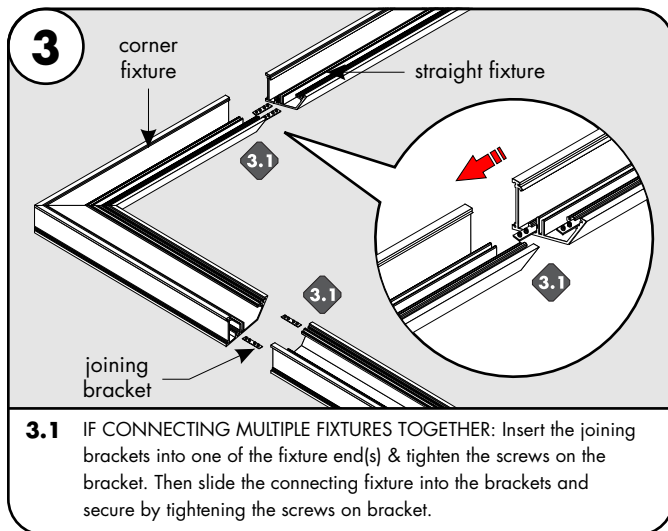
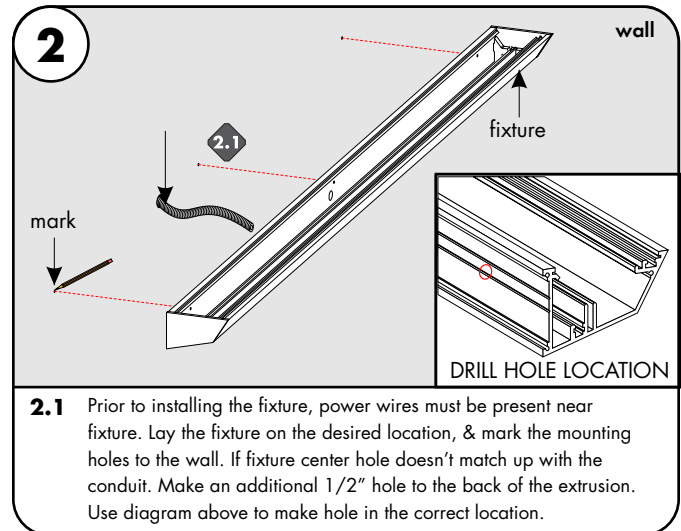
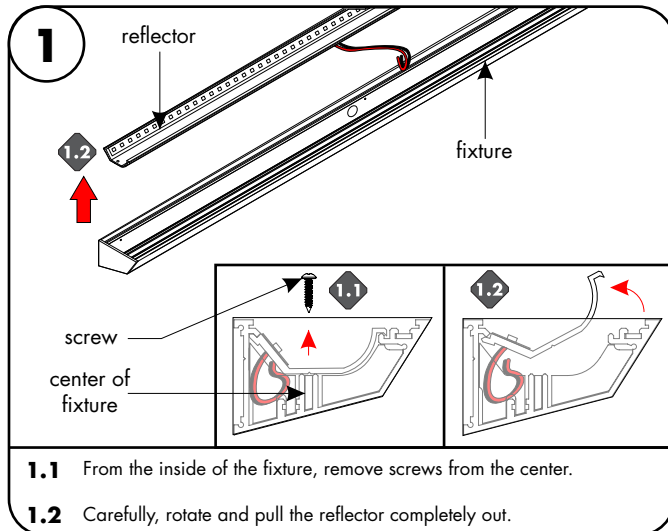

mCove - Installation Instructions

Models M-

Please read all instructions prior to installation and keep for future reference!

1. PRODUCT TO BE INSTALLED BY A QUALIFIED ELECTRICIAN.
2. USE ONLY WITH CLASS 2 POWER UNIT.
3. 24 VOLTS DC.
4. SUITABLE FOR DAMP LOCATIONS.
5. SURFACE MOUNT ONLY.
6. SUITABLE FOR INSTALLATION WITHIN THE CLOSET STORAGE SPACE.
7. INHERENTLY PROTECTED.
8. FIXTURE SHOULD BE INSTALLED BY TWO PEOPLE.



REV0.2
01272026

2 / 4



7777 Merrimac Ave
Niles, IL 60714
T 224.333.6033
F 224.757.7557
info@luminii.com
www.luminii.com

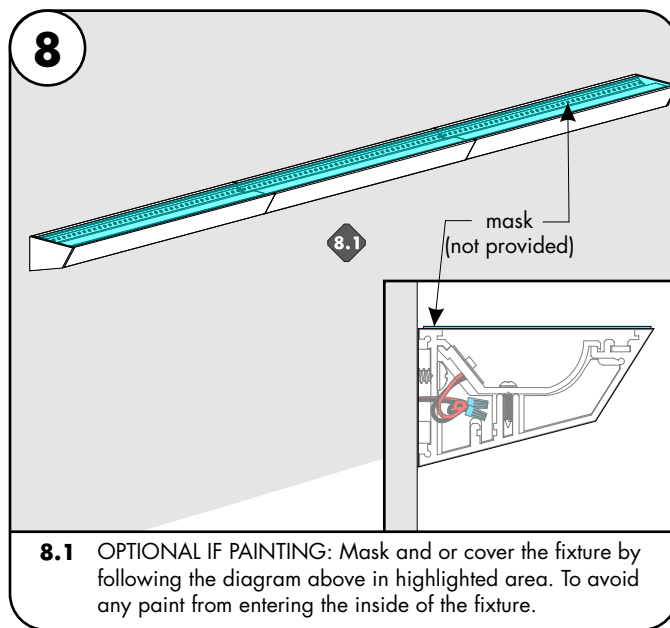
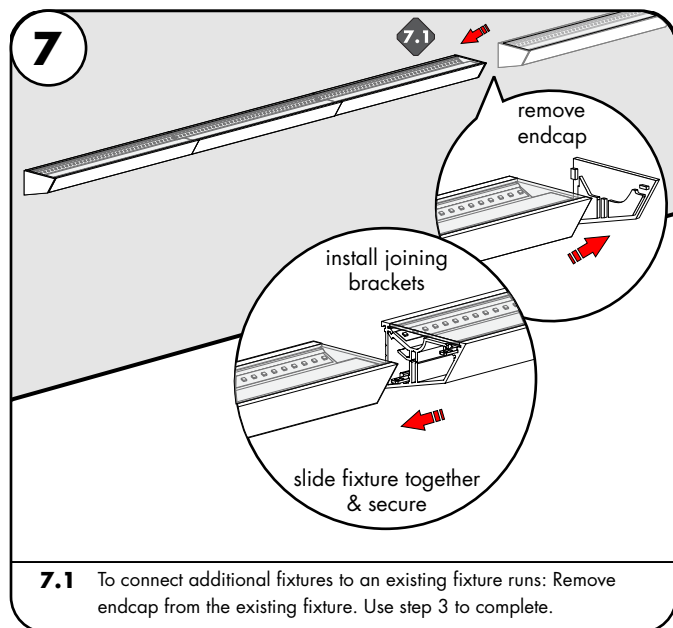

mCove sample layout

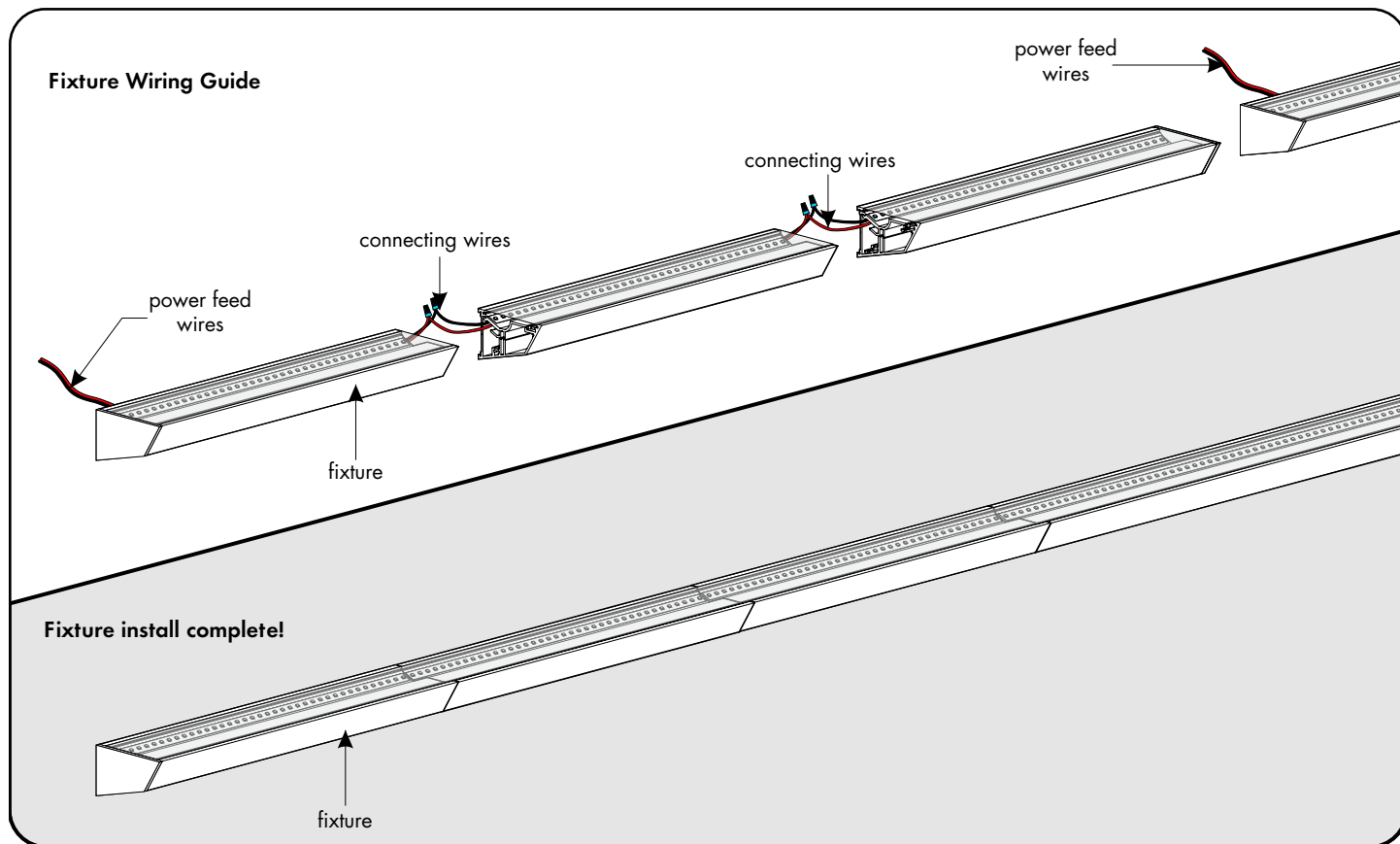

mCove - Installation Instructions

Models M-

Please read all instructions prior to installation and keep for future reference!

- | | |
|--|---|
| 1. PRODUCT TO BE INSTALLED BY A QUALIFIED ELECTRICIAN. | 5. SURFACE MOUNT ONLY. |
| 2. USE ONLY WITH CLASS 2 POWER UNIT. | 6. SUITABLE FOR INSTALLATION WITHIN THE CLOSET STORAGE SPACE. |
| 3. 24 VOLTS DC. | 7. INHERENTLY PROTECTED. |
| 4. SUITABLE FOR DAMP LOCATIONS. | 8. FIXTURE SHOULD BE INSTALLED BY TWO PEOPLE. |



REVO.2
01272026

3 / 4



7777 Merrimac Ave
Niles, IL 60714
T 224.333.6033
F 224.757.7557
info@luminii.com
www.luminii.com

Power Supply Wiring Diagram

Note: Prior to installation all 24VDC wires must be present near fixture. Refer to the power supply installation instructions for additional information.



Static White
[Wiring Diagram PDF](#)



RGB/RGBW
[Wiring Diagram PDF](#)



Warm Dim
[Wiring Diagram PDF](#)



Pixel
[Wiring Diagram PDF](#)



Tunable White
[Wiring Diagram PDF](#)

mCove - Installation Instructions

Models M-

Please read all instructions prior to installation and keep for future reference!

1. PRODUCT TO BE INSTALLED BY A QUALIFIED ELECTRICIAN.
2. USE ONLY WITH CLASS 2 POWER UNIT.
3. 24 VOLTS DC.
4. SUITABLE FOR DAMP LOCATIONS.
5. SURFACE MOUNT ONLY.
6. SUITABLE FOR INSTALLATION WITHIN THE CLOSET STORAGE SPACE.
7. INHERENTLY PROTECTED.
8. FIXTURE SHOULD BE INSTALLED BY TWO PEOPLE.



REVO.2
01272026

4 / 4



7777 Merrimac Ave
Niles, IL 60714
T 224.333.6033
F 224.757.7557
info@luminii.com
www.luminii.com

multiple powerfeed layouts

power supplies at the end of the run

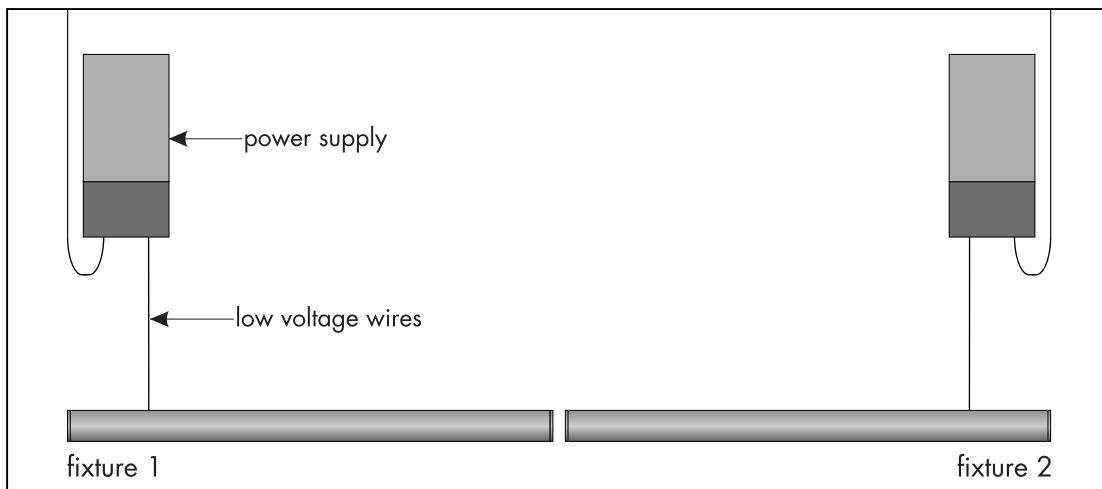

power supplies in the middle of the run

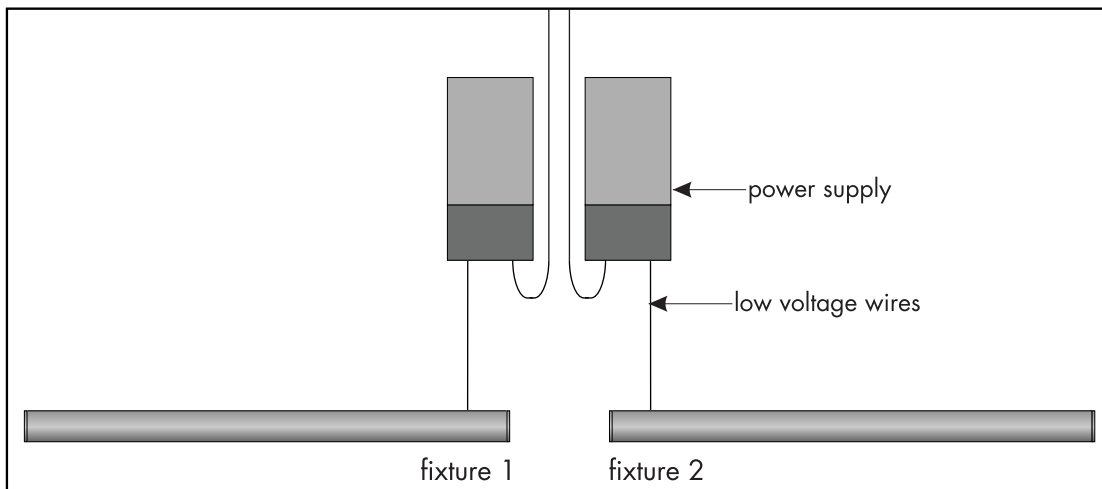

consecutive layout, NOT RECOMMENDED

