

Installation Instructions - Plexineon Surface Static Color

Models: Plexineon Fixture Surface Mount Static Color and Plexineon Rings Surface Mount Static Color

Please read all instructions prior to installation and keep for future reference!

1. PRODUCT TO BE INSTALLED BY A QUALIFIED ELECTRICIAN.
2. USE ONLY WITH CLASS 2 POWER UNIT
3. 24 VOLTS DC
4. SUITABLE FOR WET LOCATIONS
5. SURFACE MOUNT ONLY



REVO.2
01272026

1 / 4

ilight
by luminii
7777 Merrimac Ave
Niles, IL 60714
T 224.333.6033
F 224.757.7557
info@luminii.com
www.luminii.com



Plexineon Straight Run Fixture

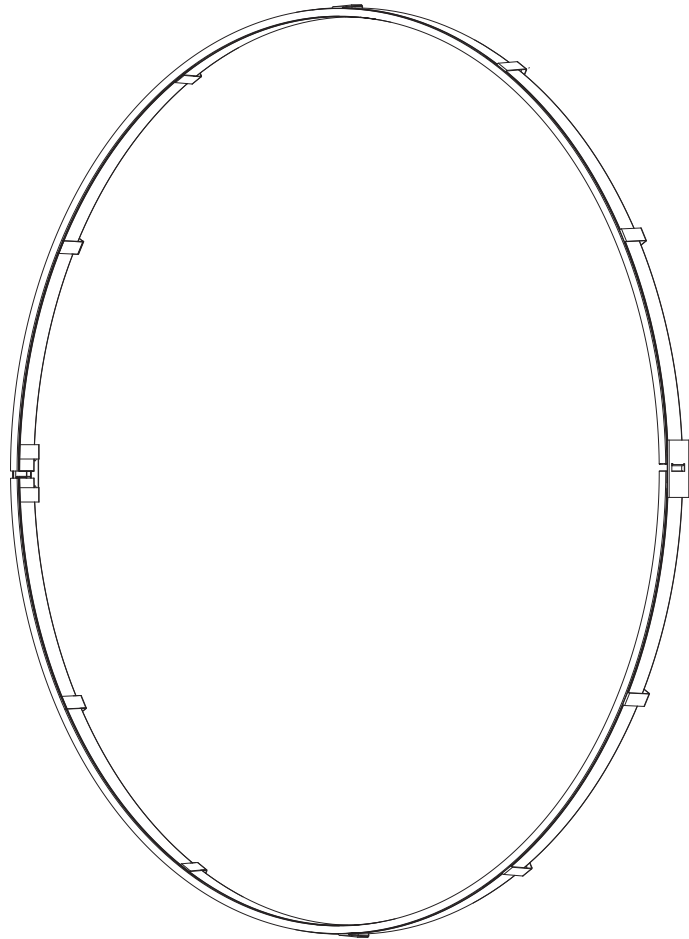

Plexineon Ring Surface Mount

Installation Instructions - Plexineon Surface Static Color

Models: Plexineon Fixture Surface Mount Static Color and Plexineon Rings Surface Mount Static Color

Please read all instructions prior to installation and keep for future reference!

1. PRODUCT TO BE INSTALLED BY A QUALIFIED ELECTRICIAN.
2. USE ONLY WITH CLASS 2 POWER UNIT
3. 24 VOLTS DC
4. SUITABLE FOR WET LOCATIONS

5. SURFACE MOUNT ONLY



REV. 02
01272026

2 / 4

ilight
by luminii
7777 Merrimac Ave
Niles, IL 60714
T 224.333.6033
F 224.757.7557
info@luminii.com
www.luminii.com

1

NOTE: Prior to installation all 24VDC wires must be present within 72" of the installation. Refer to the power supply installation instruction for additional information.

NOTE: More than one person is recommended for this installation.

- 1.1** Once the location or pattern is determined for Plexineon to be installed, start off by marking the area. Amount of mounting clips may vary dependant upon pattern. Reference diagrams below.

Straight run with mounting clips

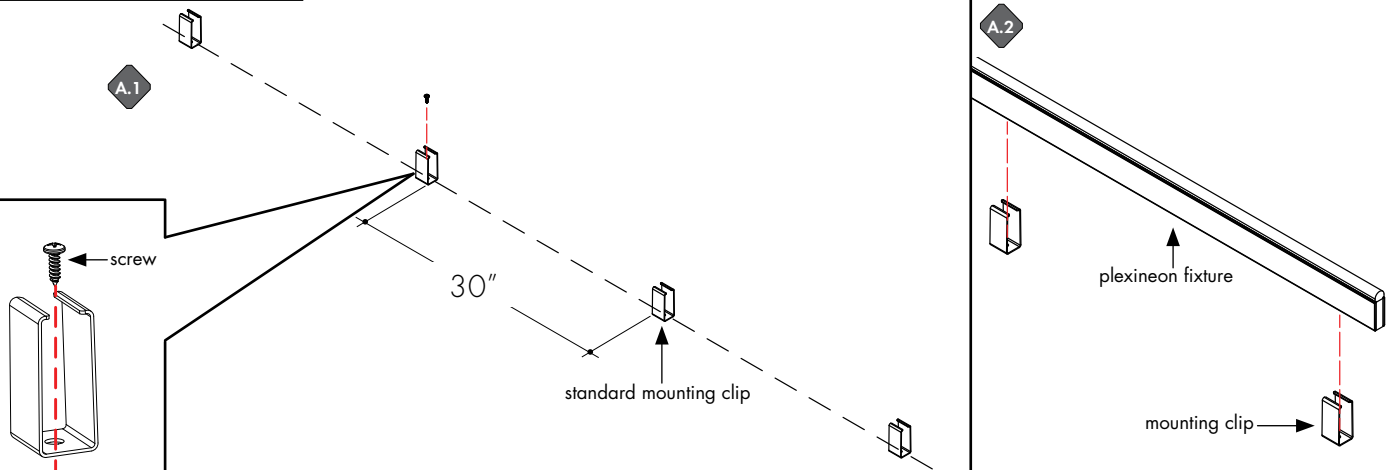

- A.1** Line up and screw on the mounting clips to the mounting holes with no greater than 30" apart. Make sure it is straight by using a level.

- A.2** Fix the plexineon fixture into installed mounting clips. See page 3 for clipping instructions.

Curved run/rings with mounting clips

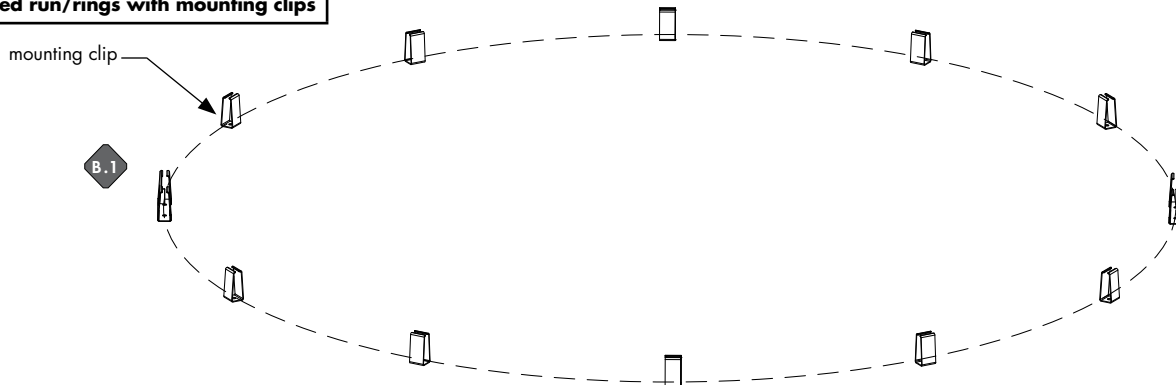

- B.1** Determine the shape of the plexineon layout, then mark the pattern onto the surface. Place the mounting clips with no greater than 30" apart. Screw onto surface.

- B.2** Fix the plexineon bend/ring fixture into installed mounting clips. See page 3 for clipping instructions.

NOTE: Standard Clips and Decorative Clips have different required spacing.

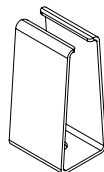

standard mounting clip
30" space



decorative mounting clip
18" space

Installation Instructions - Plexineon Surface Static Color

Models: Plexineon Fixture Surface Mount Static Color and Plexineon Rings Surface Mount Static Color

Please read all instructions prior to installation and keep for future reference!

1. PRODUCT TO BE INSTALLED BY A QUALIFIED ELECTRICIAN.
2. USE ONLY WITH CLASS 2 POWER UNIT
3. 24 VOLTS DC
4. SUITABLE FOR WET LOCATIONS

5. SURFACE MOUNT ONLY



REV. 0.2
01272026

3 / 4

ilight
by luminii
7777 Merrimac Ave
Niles, IL 60714
T 224.333.6033
F 224.757.7557
info@luminii.com
www.luminii.com

Install Fixtures into Mounting Clips

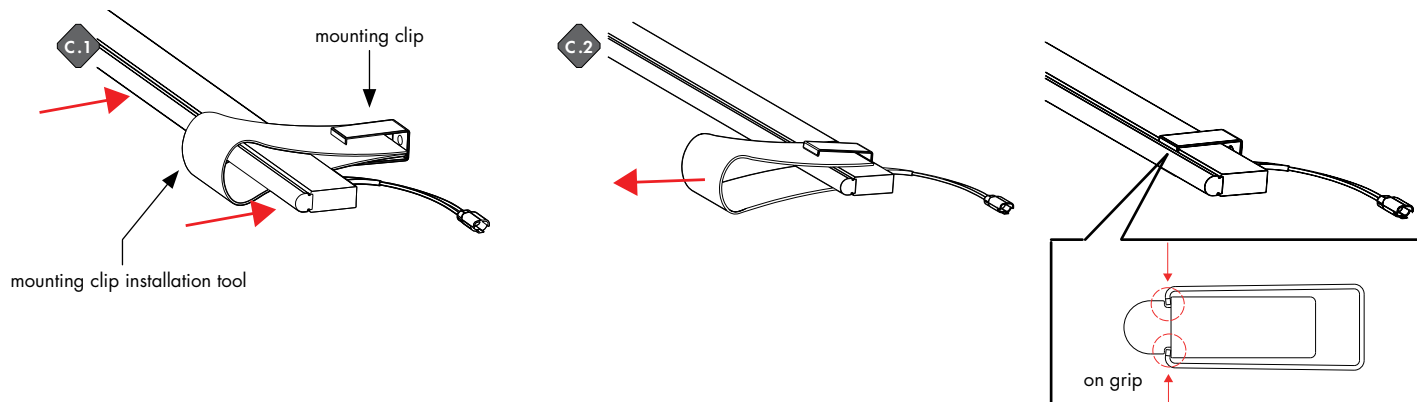

C.1 Make an U shape with mounting clip installation tool, insert two edges into mounting clip. Place plexineon fixture inside the shape. Then push the fixture into clip.

C.2 Remove the tool. Make sure mounting clip is clipped right on the grip.

2

- 2.1** Connect +24 VDC red from the Plexineon to the power supply +24 VDC red wire. Connect -24 VDC black wire from the Plexineon to power supply -24 VDC black wire.

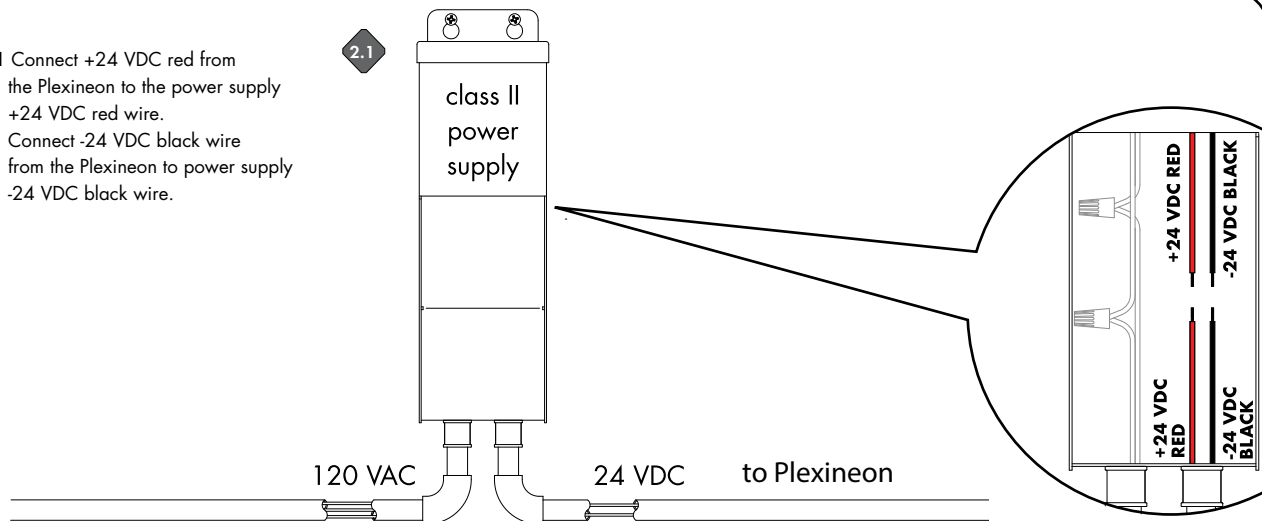

Multiple Fixtures



Installation Instructions - Plexineon Surface Static Color

Models: Plexineon Fixture Surface Mount Static Color and Plexineon Rings Surface Mount Static Color

Please read all instructions prior to installation and keep for future reference!

1. PRODUCT TO BE INSTALLED BY A QUALIFIED ELECTRICIAN.
2. USE ONLY WITH CLASS 2 POWER UNIT
3. 24 VOLTS DC
4. SUITABLE FOR WET LOCATIONS
5. SURFACE MOUNT ONLY



REVO.2
01272026

4 / 4

ilight
by luminii
7777 Merrimac Ave
Niles, IL 60714
T 224.333.6033
F 224.757.7557
info@luminii.com
www.luminii.com

Power Supply Wiring Diagram

Note: Prior to installation all 24VDC wires must be present near fixture. Refer to the power supply installation instructions for additional information.

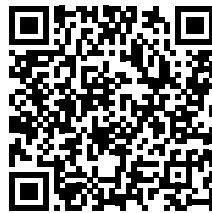

Static White
[Wiring Diagram PDF](#)